

PRODUCT GUIDE

TILLERS, FINISH MOWERS
& FLAIL MOWERS



TITAN

IMPLEMENT

[423] 334-0012

WWW.TITANIMPLEMENT.COM



WE ARE FIELD PROVEN

TITAN IMPLEMENT manufactures a wide range of implements and attachments that will work as hard as you do. Our agricultural equipment is designed to exceed your expectations and provide you with the best value-for-cost.

OUR MISSION is to provide the most value on the market, to unearth the best in our employees, and to excel in our field so that our customers can conquer theirs.

OUR STORY began in 2014 when Mike Turner and his son, Baily, launched a company that would take the market by storm. Their family has a history with agriculture (their family farm dates back to 1898) and they have over 35 years of experience in the manufacturing business. It's this combination that gives Titan Implement the edge against our competition, because we use what we make.

WE ARE TITAN IMPLEMENT



TITAN

IMPLEMENT

CONTENTS

FMA CHAIN-DRIVE TILLER.....	4
UL GEAR-DRIVE TILLER.....	5
UM ROTARY TILLER.....	6
UH ROTARY TILLER.....	7
VH EXTREME DUTY TILLER.....	8
SGM FINISH MOWER.....	9
FL BULLY FLAIL MOWER.....	10
FMH FLAIL MOWER.....	11
BPF FLAIL MOWER.....	12

FMA SERIES CHAIN-DRIVE TILLER

TITAN
IMPLEMENT



	FMA-125
OVERALL WIDTH	53"
TILLING WIDTH	49"
TRACTOR HP RANGE	13 - 25
3-POINT HITCH TYPE	Category 1
NUMBER OF FLANGES ON ROTOR	6
NUMBER OF TINES PER FLANGE	4
NUMBER OF TINES	24
WEIGHT (without PTO)	309 LBS
PTO INPUT SPEED	540 RPM
MAX WORKING DEPTH	4.75"
ROTOR TUBE DIAMETER	2"
ROTOR SWING DIAMETER	12.5"

FMA CHAIN-DRIVE TILLER

The FMA series is suitable for tractors from 13 to 25 hp with category 1 hitch.

The FMA models are light-duty and most appropriate for gardening and horticulture.



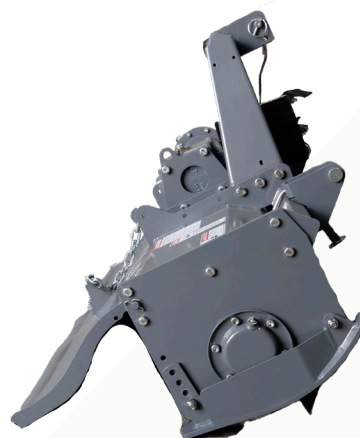
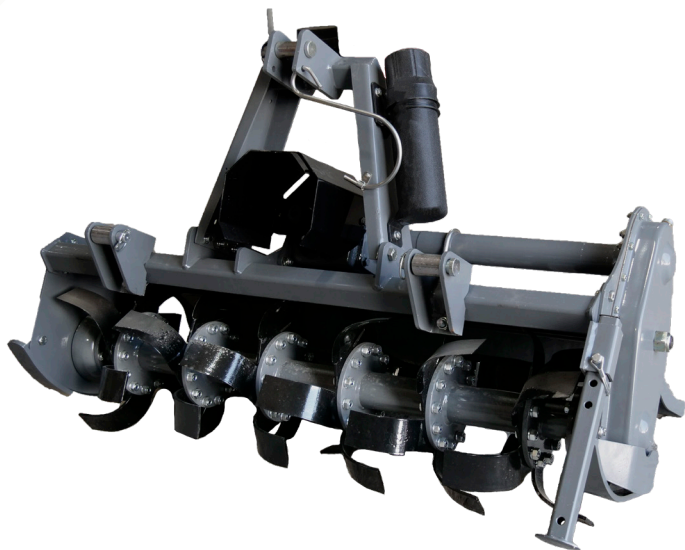

	UL-48	UL-60
OVERALL WIDTH	53"	65"
TILLING WIDTH	48"	60"
TRACTOR HP RANGE	20 - 25	25 - 40
3-POINT HITCH TYPE	Category 1	
NUMBER OF FLANGES ON ROTOR	6	7
NUMBER OF TINES PER FLANGE	6	
NUMBER OF TINES	36	42
WEIGHT (without PTO)	397 LBS	441 LBS
PTO INPUT SPEED	540 RPM	
MAX WORKING DEPTH	7"	
ROTOR TUBE DIAMETER	3"	
ROTOR SWING DIAMETER	15"	

UL GEAR-DRIVE TILLER

The UL series is suitable for tractors from 20 to 40 hp with category 1 hitch.

The UL models are light-duty and dependable, appropriate for gardening and horticulture.



UM SERIES ROTARY TILLER

TITAN
IMPLEMENT

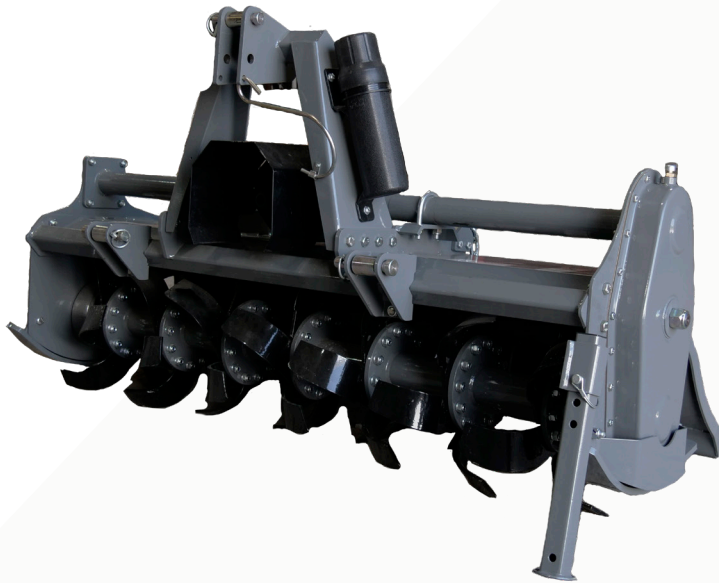

	UM-56	UM-72
OVERALL WIDTH	65"	78"
TILLING WIDTH	60"	73"
TRACTOR HP RANGE	25 - 50	
3-POINT HITCH TYPE	Category 1	
NUMBER OF FLANGES ON ROTOR	7	9
NUMBER OF TINES PER FLANGE	6	
NUMBER OF TINES	42	54
WEIGHT (without PTO)	578 LBS	684 LBS
PTO INPUT SPEED	540 RPM	
MAX WORKING DEPTH	7"	
ROTOR TUBE DIAMETER	3"	
ROTOR SWING DIAMETER	17"	

UM ROTARY TILLER

The UM series is suitable for tractors from 25 to 50 hp with a category 1 hitch.

The UM models are medium-duty and dependable on demanding soils, appropriate also for vineyards and orchards.





	UH-84
OVERALL WIDTH	90"
TRACTOR HP RANGE	50 - 65
TILLING WIDTH	85"
3-POINT HITCH TYPE	Category 1 & 2
NUMBER OF FLANGES ON ROTOR	9
NUMBER OF TINES PER FLANGE	6
NUMBER OF TINES	54
WEIGHT (without PTO)	993
PTO INPUT SPEED	540 RPM
MAX WORKING DEPTH	8"
ROTOR TUBE DIAMETER	4"
ROTOR SWING DIAMETER	19"

UH ROTARY TILLER

The UH series is suitable for tractors from 50 to 65 hp with a category 2 hitch. The UH models are heavy-duty and dependable, cutting through very demanding and stony soils.



VH SERIES EXTREME DUTY TILLER

TITAN
IMPLEMENT



	VH-90
OVERALL WIDTH	95"
TILLING WIDTH	90"
TRACTOR HP RANGE	75 - 125
3-POINT HITCH TYPE	Category 2 or 3
NUMBER OF FLANGES ON ROTOR	9
NUMBER OF TINES PER FLANGE	6
NUMBER OF TINES	54
WEIGHT (without PTO)	1557 LBS
PTO INPUT SPEED	540 RPM
MAX WORKING DEPTH	9"
ROTOR TUBE DIAMETER	3.5"
ROTOR SWING DIAMETER	17"

VH SERIES EXTREME DUTY TILLER

The VH series is suitable for tractors from 75 to 125 hp with category 2 or 3 hitch.

The VH models are heavy-duty and dependable, cutting through very demanding and stony soils. The speed of the rotor can be adjusted.

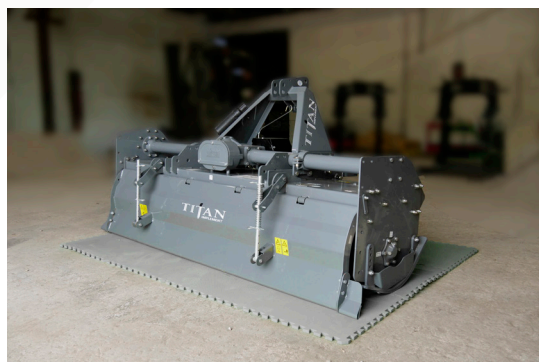

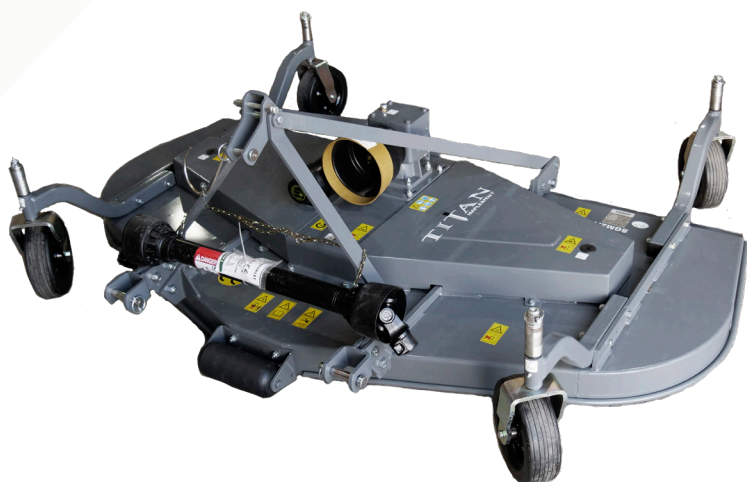

	SGM-4	SGM-5	SGM-6	SGM-7
OVERALL WIDTH	52"	65"	76"	89"
WORKING WIDTH	48"	60"	72"	84"
TRACTOR HP RANGE	20-50 HP	25-50 HP	30-50 HP	35-60 HP
CUTTING HEIGHT	1" - 4"			
3-POINT HITCH TYPE	Category 1			
NUMBER OF BLADES	3			
PTO INPUT SPEED	540 RPM			
DECK THICKNESS	7 Gauge			
PTO SHAFT TYPE	Series 4			
WEIGHT (without PTO)	450 LBS	499 LBS	554 LBS	662 LBS
BELTS	2			
FRONT ROLLER	STANDARD			

SGM FINISH MOWER

The SGM series suits 20-60 hp tractors with a category 1 hitch and can be used in front or behind the tractor.

The SGM grooming mower will make your land look sharp with fine and controlled cuts in small to medium grass, thanks to its 3 blades.



FL SERIES BULLY FLAIL MOWER

TITAN
IMPLEMENT

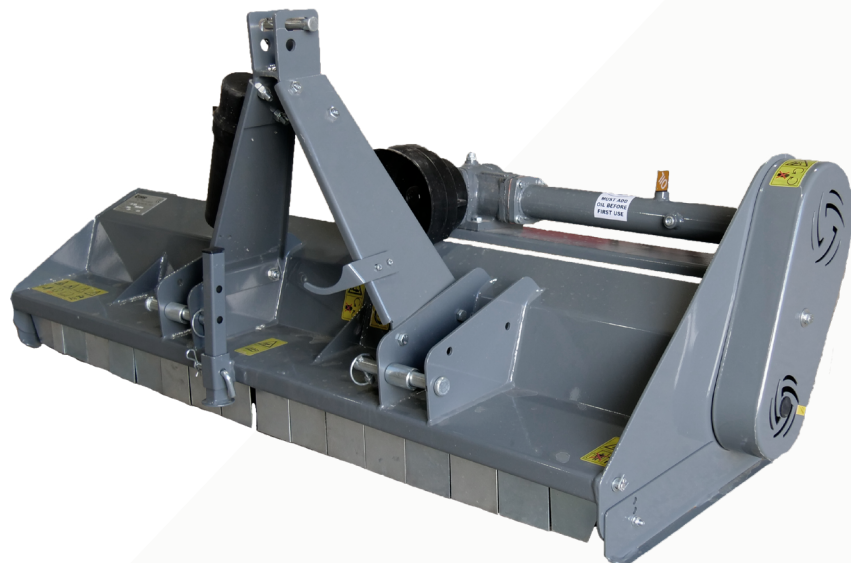

	FL-135	FL-165
OVERALL WIDTH	57"	69"
MOWING WIDTH	52"	64"
TRACTOR HP RANGE	23 - 35	25 - 40
3-POINT HITCH TYPE	Category 1	
NUMBER OF HAMMERS	24	
NUMBER OF BLADES	48	
ROLLER THICKNESS	10 Gauge	
ROTOR THICKNESS	5/16"	
FRAME THICKNESS	9 Gauge	
WEIGHT (without PTO)	386 LBS	518 LBS
BELTS	3	3

FL BULLY FLAIL MOWER

The FL flail mower range is suitable for tractors from 23 hp to 40 hp with category 1 hitch. The FL mower is compact and light, making it a perfect choice for sub-compact or compact tractors. It's recommended for weekend farmers and gardening. It's available with hammers and blades. Hammers provide the mower with 1" cutting capacity.



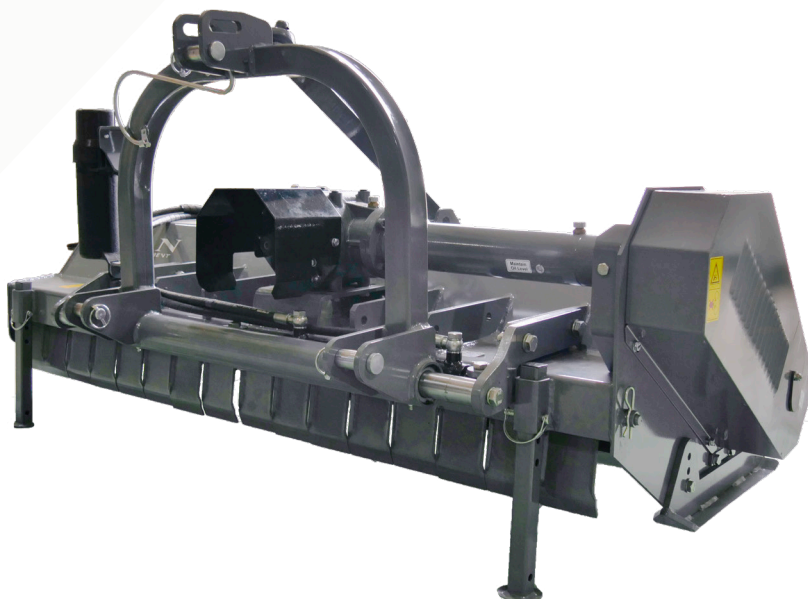

	FMH-160	FMH-175	FMH-205	FMH-220
OVERALL WIDTH	69"	75.5"	87.4"	93"
MOWING WIDTH	63"	69"	80.7"	86.5"
TRACTOR HP RANGE	35-70 HP	40-70 HP	45-70 HP	50-70 HP
3-POINT HITCH TYPE	Category 1			
HYDRAULIC OFFSET	12"			
NUMBER OF HAMMERS	20	22	26	28
WEIGHT (without PTO)	908 LBS	957 LBS	1063	1116
BELTS	4			

FMH FLAIL MOWER

The FMH series is suitable for tractors from 35 hp to 70 hp with category 1 hitch.

It utilizes a wide working width (up to 86-inch reach) and has multi-purpose capability allowing it to mow grass and brush (1.5-inch thickness) by means of flails or hammers. Hydraulic side shift, rear roller, and rakes standard. Hammers are standard and flail knives are optional.



BPF SERIES FLAIL MOWER

TITAN
IMPLEMENT

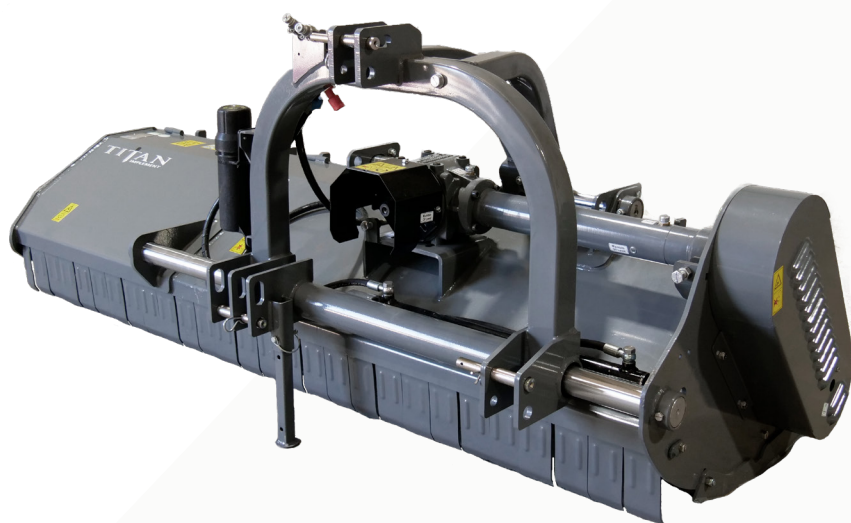

	BPF-225	BPF-250
OVERALL WIDTH	96"	106"
WORKING WIDTH	87"	98"
TRACTOR HP RANGE	50 - 100	
3-POINT HITCH TYPE	Category 2	
HYDRAULIC OFFSET	15"	
NUMBER OF HAMMERS	20	24
ROLLER DIAMETER	6.69"	
ROTOR DIAMETER	6.69"	
WEIGHT (without PTO)	1726 LBS	1907 LBS
BELTS	4	5

BPF FLAIL MOWER

The BPF series is suitable for tractors from 50 hp to 100 hp with a category 2 hitch. It's a powerful piece of equipment with multi-purpose capability. Up to 3" cutting capacity.

- Opened deck design for easy maintenance
- Double deck design
- Hydraulic side shift, rear roller, and rakes standard
- Hammers standard



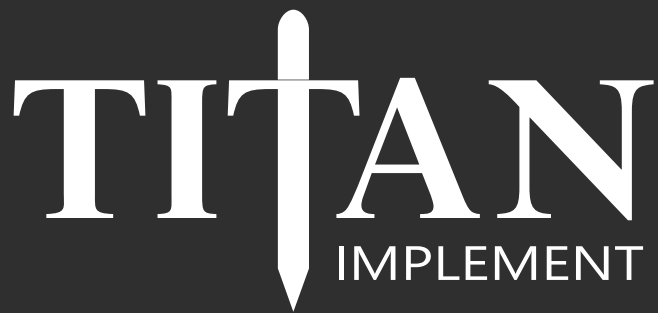

**WITH A WIDE RANGE OF IMPLEMENTS AND
ATTACHMENTS, TITAN HAS YOU COVERED.**

Find your nearest Titan Implement Dealer at
www.titanimplement.com/dealer-locator



Find Full Catalogs at
www.TitanImplement.com



423.405.5150

WWW.TRAILBLAZERATTACHMENTS.COM



TB-FLEX

FRONT-ATTACH MOWER

The best front-attach mower is here. We listened to feedback from TrailBlazer customers and designed a game-changing new front-attach mower. The TB-Flex offers a *free-floating cutter deck* that follows the contours of the ground, and it does so without scalping or gouging. We've included *counter balance tubes* to ensure a more balanced operation.

Adjusting cutting positions now easier than ever. A single, red-handled pin is used to adjust any and all positions. *No cumbersome steel strap or chain needed!*

Made for you. There are four mounting options and two motor options available. With double sided cutter blades, Eaton Charlynn hydraulic motor and a 2-Year TrailBlazer Motor Warranty.





3515

15' FLEX-WING CUTTER

Introducing the new 15' Flex Wing cutter from Titan Implement. Engineered to disrupt the industry with next level performance at a truly affordable price. The 3515 is manufactured with a smooth top deck, a 3.5" cut capacity, multiple tire options, and an optional light kit for road towing.

Our standard options include:

- Chain guards deck rings
- Powder coat paint
- Press formed blade
- And a rock solid reinforced deck.

Contact Titan Implement or visit our website for additional information.

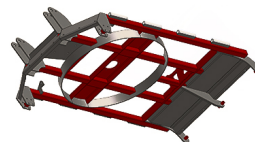
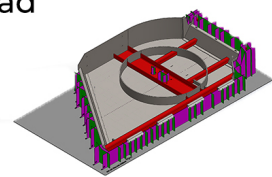

PROUD MEMBER OF



**FARM EQUIPMENT
MANUFACTURERS
ASSOCIATION**

TITAN IMPLEMENT, LLC.

P.O. BOX 649

232 INDUSTRIAL LANE

DECATUR, TN 37322

PHONE: (423) 334-0012

FAX: (423) 334-0023

WWW.TITANIMPLEMENT.COM